

EBTS. DRAFT BEER TOWERS

CATALOGUE



2024

HOLTEC
SOLUTIONS

Denmark Distributor

draft beer towers manufacturer

EBTS.

ABOUT US

We are proud of our 29 years of experience in the production of dispensing systems. We make sure that every bar gets a suitable dispenser.

Products are made only from best quality stainless steel, copper and brass. With developing new methods and processes in production the dispensers are easy to install, use and maintain.

Appearance represents your brand. We love to play with design. Adding wood and acrylic for modern and attractive look. Using latest techniques of engraving, laser printing, wrapping and water transfer to make the look different and your brand visible.

welcome to our world of
dispensing towers



Industrial Line

A very popular style that impresses again and again.

Robust flanges and huge decorative screws are the trademark of the Industrial Line. Many alphabetical shapes.



Colours

- SS- Stainless steel
- PVD Gold
- PVD Copper
- PC- Powder Coated- RAL to select
- WTP-Water transfer printing



Advertising

- Front Light
- Lollipop Light
- Laser Cut Light
- Digital Light
- Engraved Branding
- Laser Printed
- Wrapped Branding
- Tap Handles



Mounting

- Mounting Tube
- Mounting Screw
- Mounting Clamp



123 Cheers!

- Tap of your Choice
- Water-cooled Lines
- Drainer- Dimensions to select

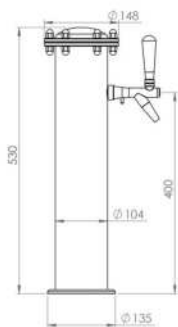

INDUSTRIAL I

1-3 TAPS

CUSTOMISE: COLOUR, SIZE, FIXATION

sku I1

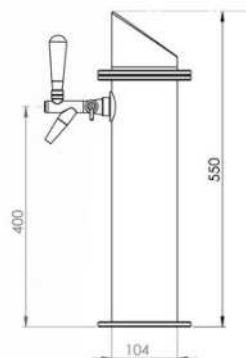

INDUSTRIAL I2

1-3 TAPS

CUSTOMISE: COLOUR, SIZE, FIXATION

sku I2

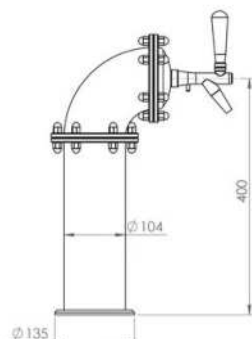

INDUSTRIAL J

1-2 TAPS

CUSTOMISE: COLOUR, SIZE, FIXATION

sku IJ



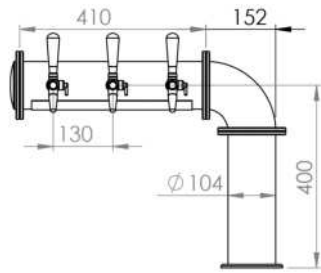

INDUSTRIAL L

2-6 TAPS

CUSTOMISE: COLOUR, SIZE, FIXATION

sku IL

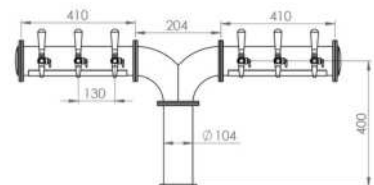

INDUSTRIAL Y

2+2, 3+3, 4+4 TAPS

CUSTOMISE: COLOUR, SIZE, FIXATION

sku IY



INDUSTRIAL YY

2+2+2, 3+3+3, 4+4+4 TAPS

CUSTOMISE: COLOUR, SIZE, FIXATION

sku IYY

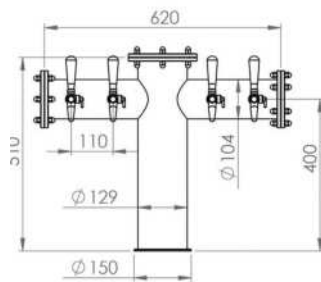

INDUSTRIAL +

4-10TAPS

CUSTOMISE: COLOUR, SIZE, FIXATION

sku I+

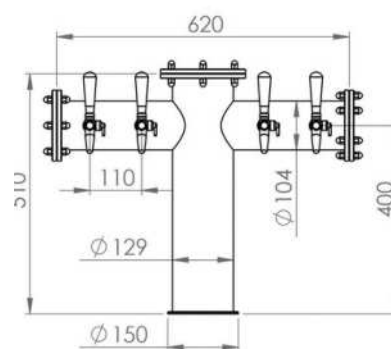

INDUSTRIAL +3

4-10TAPS

CUSTOMISE: COLOUR, SIZE, FIXATION

sku I+3

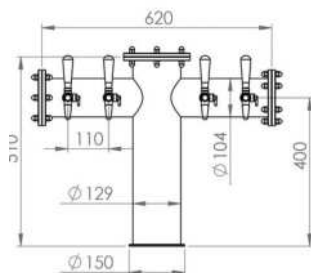

INDUSTRIAL +2

3-9TAPS

CUSTOMISE: COLOUR, SIZE, FIXATION

sku I+2



INDUSTRIAL T

2-6TAPS

CUSTOMISE: COLOUR, SIZE, FIXATION

sku IT

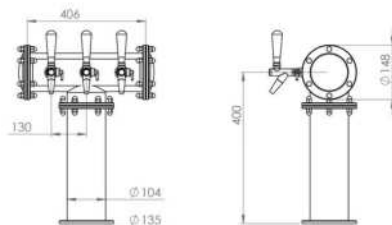

INDUSTRIAL TT

6-18TAPS

CUSTOMISE: COLOUR, SIZE, FIXATION

sku ITT

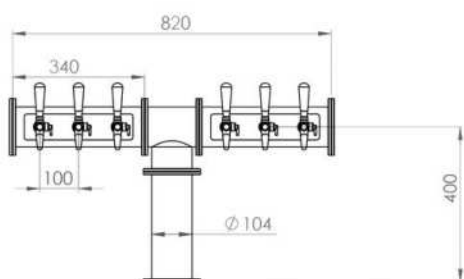

INDUSTRIAL T2

2+2, 3+3, 4+4TAPS

CUSTOMISE: COLOUR, SIZE, FIXATION

sku IT2



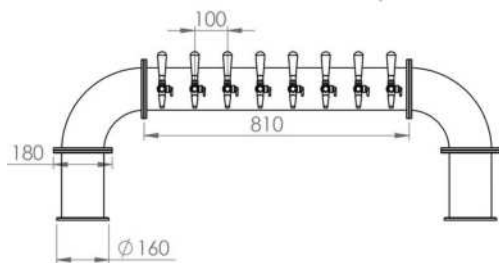

INDUSTRIAL U-XL Ø129

6-16 TAPS

CUSTOMISE: COLOUR, SIZE, FIXATION

sku IUXL

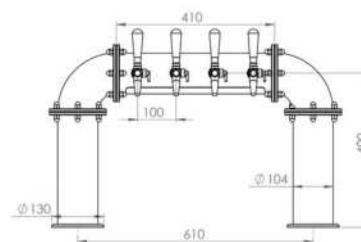

INDUSTRIAL U-M Ø104

4-12 TAPS

CUSTOMISE: COLOUR, SIZE, FIXATION

sku IUM

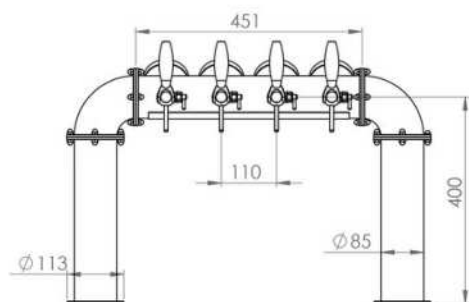

INDUSTRIAL U-S Ø85

4-6 TAPS

CUSTOMISE: COLOUR, SIZE, FIXATION

sku IUS



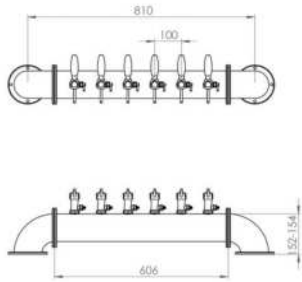

INDUSTRIAL SHORT U

3-12 TAPS

CUSTOMISE: COLOUR, SIZE, FIXATION

sku ISU

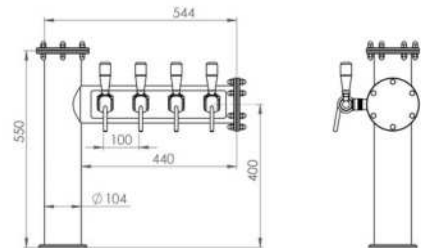

INDUSTRIAL L2

2-6 TAPS

CUSTOMISE: COLOUR, SIZE, FIXATION

sku IL2

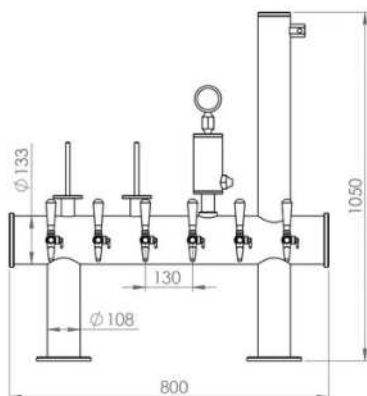

INDUSTRIAL TEXAS

4-12 TAPS

CUSTOMISE: COLOUR, SIZE, FIXATION

sku ITEX

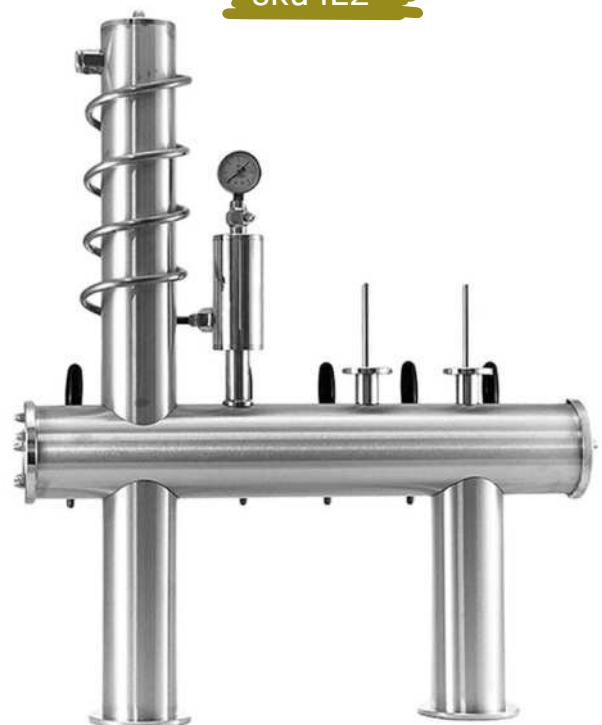

Basic Line

A true classic that looks good in any setting. Clean, straight lines and numerous advertising options make the Basic Line attractive.



Colours

- SS- Stainless steel
- PVD Gold
- PVD Copper
- PC- Powder Coated- RAL to select
- WTP-Water transfer printing



Advertising

- Front Light
- Lollipop Light
- Laser Cut Light
- Digital Light
- Engraved Branding
- Laser Printed
- Wrapped Branding
- Tap Handles



Mounting

- Mounting Tube
- Mounting Screw
- Mounting Clamp



123 Cheers!

- Tap of your Choice
- Water-cooled Lines
- Drainer- Dimensions to select

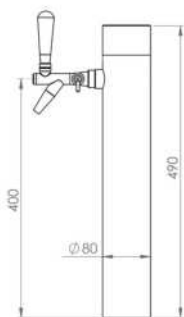

BASIC I XS-L(Ø80-Ø114)

1-3 TAPS

CUSTOMISE: COLOUR, SIZE, FIXATION

sku BIXS

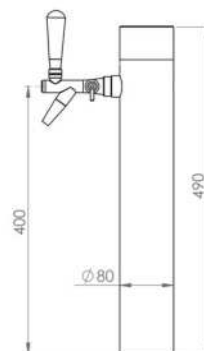

BASIC I XS-L(Ø80-114)

1-3TAPS

CUSTOMISE: COLOUR, SIZE, FIXATION

sku BIM

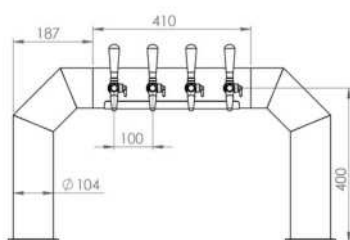

BASIC U

2-6TAPS

CUSTOMISE: COLOUR, SIZE, FIXATION

sku BU



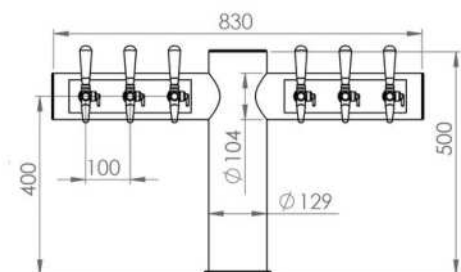

BASIC +

2+2,3+3,4+4TAPS
CUSTOMISE: COLOUR, SIZE, FIXATION

sku B+

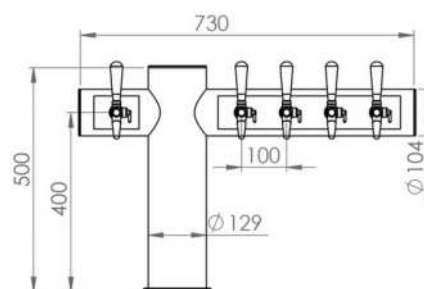

BASIC +2

3-8TAPS
CUSTOMISE: COLOUR, SIZE, FIXATION

sku B+2

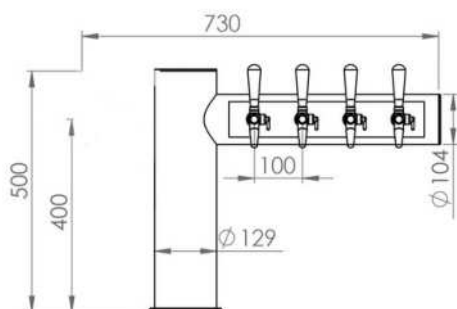

BASIC L

2-6TAPS
CUSTOMISE: COLOUR, SIZE, FIXATION

sku BL



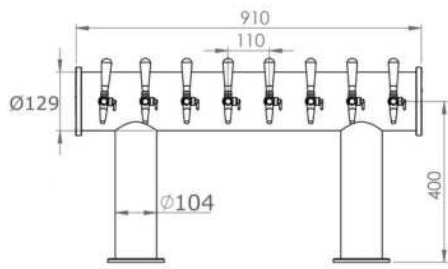

BASIC TT

8-20TAPS

CUSTOMISE: COLOUR, SIZE, FIXATION

sku BTT

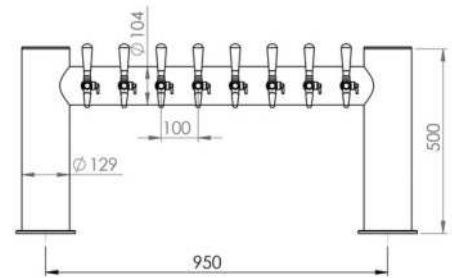
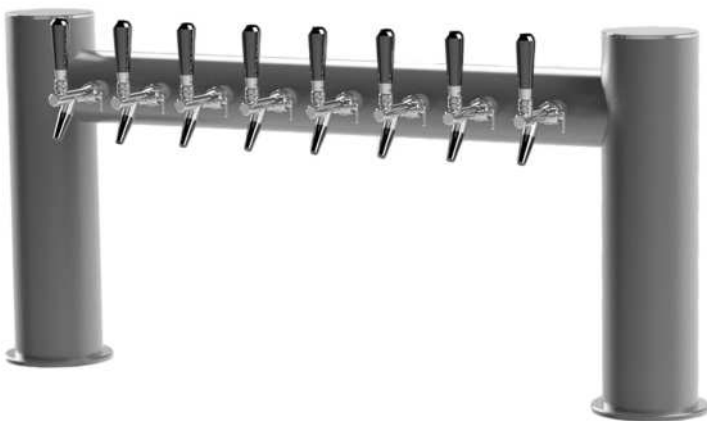

BASIC H

8-20TAPS

CUSTOMISE: COLOUR, SIZE, FIXATION

sku BH

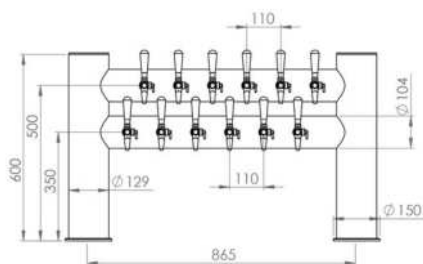

BASIC H2

12-24TAPS

CUSTOMISE: COLOUR, SIZE, FIXATION

sku BH2

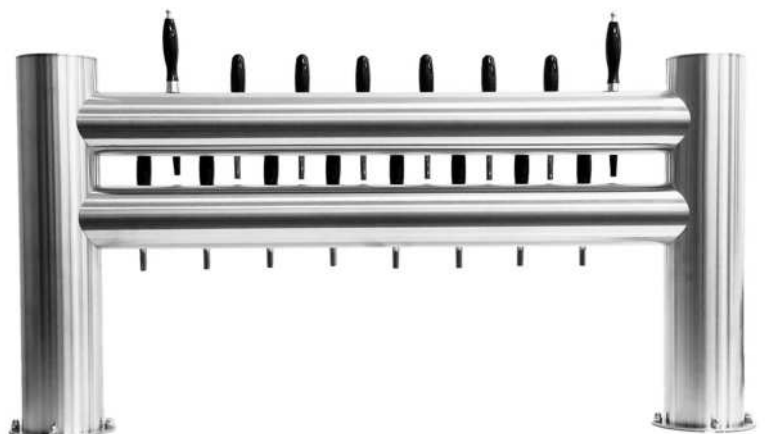



BASIC H3

12-24TAPS

CUSTOMISE: COLOUR, SIZE, FIXATION

sku BH3

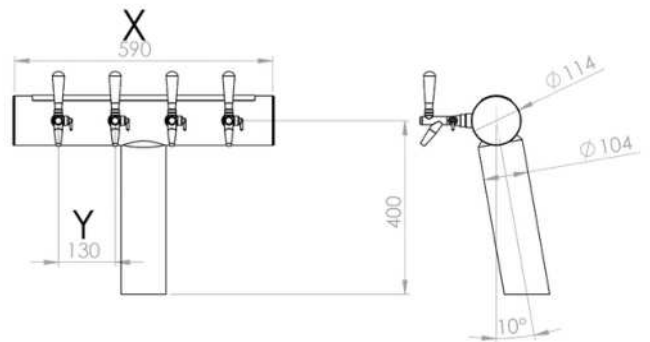

BASIC T/

3-8TAPS

CUSTOMISE: COLOUR, SIZE, FIXATION

sku BT/

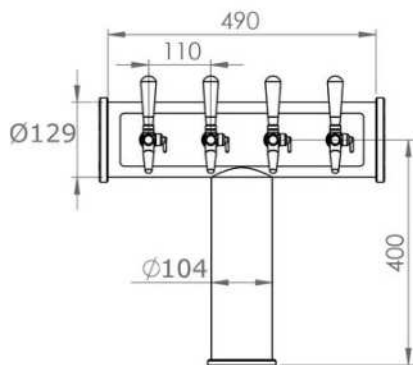

BASIC T

3-8TAPS

CUSTOMISE: COLOUR, SIZE, FIXATION

sku BT



Angled line

To a true classic we add angled finish 45degree, that turns basic style into aggressive and bold .Many alphabetical shapes and many advertising options.



Colours

- SS- Stainless steel
- PVD Gold
- PVD Copper
- PC- Powder Coated- RAL to select
- WTP-Water transfer printing



Advertising

- Front Light
- Lollipop Light
- Laser Cut Light
- Digital Light
- Engraved Branding
- Laser Printed
- Wrapped Branding
- Tap Handles



Mounting

- Mounting Tube
- Mounting Screw
- Mounting Clamp



123 Cheers!

- Tap of your Choice
- Water-cooled Lines
- Drainer- Dimensions to select

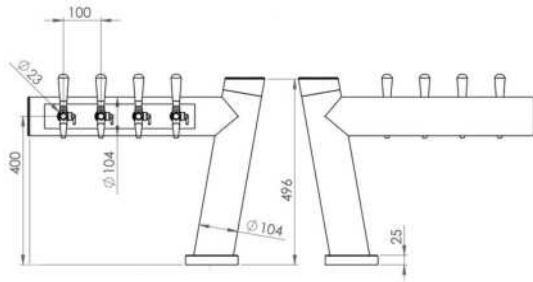

BASIC L/

3-7 TAPS

CUSTOMISE: COLOUR, SIZE, FIXATION

sku BL/

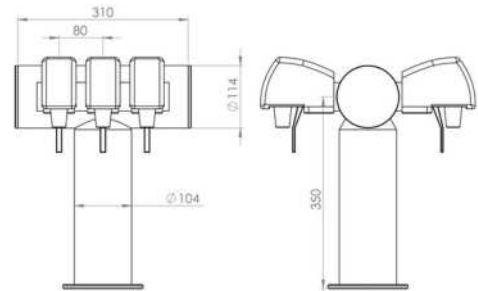

BASIC DOUBLE T

4-8TAPS

CUSTOMISE: COLOUR, SIZE, FIXATION

sku BDT

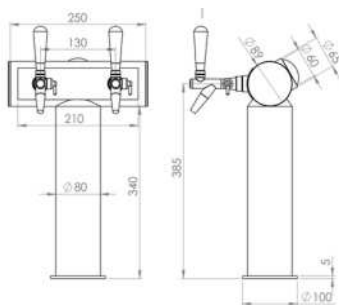

BASIC T WATER-INTEGRATED LIGHT

1-6TAPS

CUSTOMISE: COLOUR, SIZE, FIXATION

sku BTXS



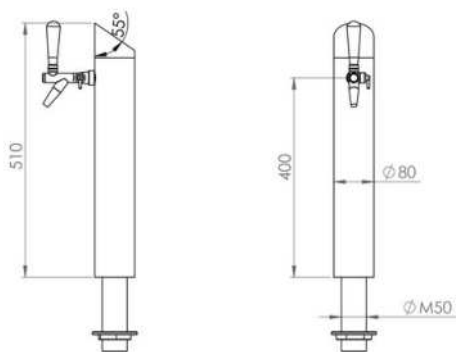

ANGLED I-XS(Ø80)

1TAPS
CUSTOMISE: COLOUR, SIZE, FIXATION

sku AIXS

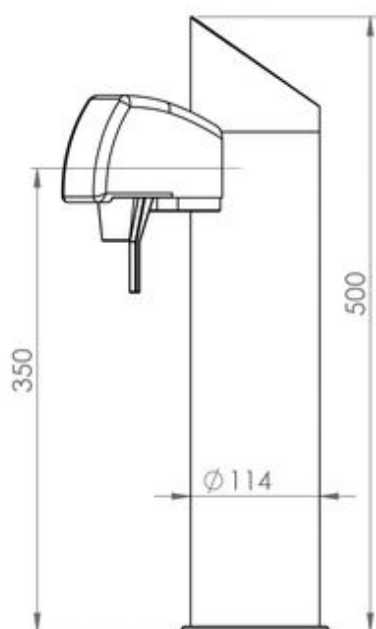

ANGLED I-M(Ø104)

1-3TAP
CUSTOMISE: COLOUR, SIZE, FIXATION

sku AIM

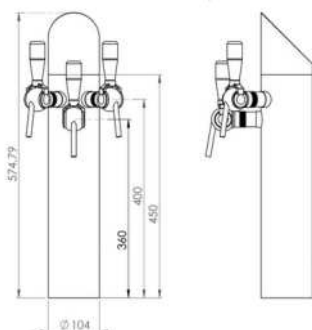

ANGLED I-M,L (Ø104, 114)

1-3TAPS
CUSTOMISE: COLOUR, SIZE, FIXATION

sku AIM



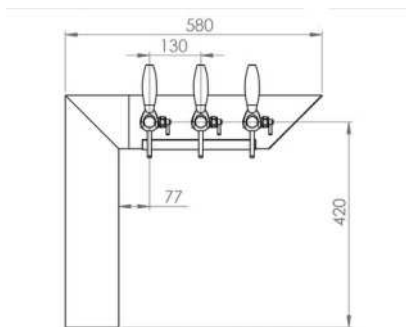

ANGLED L

2-6TAPS

CUSTOMISE: COLOUR, SIZE, FIXATION

sku AL

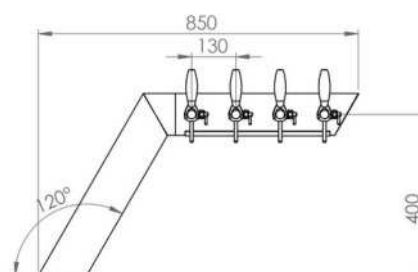

ANGLED L2

2-6TAPS

CUSTOMISE: COLOUR, SIZE, FIXATION

sku AL2

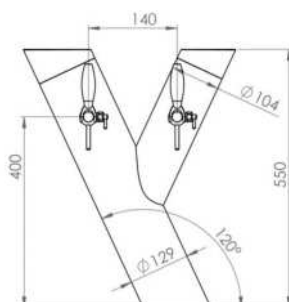

ANGLED Y

2TAPS

CUSTOMISE: COLOUR, SIZE, FIXATION

sku AY



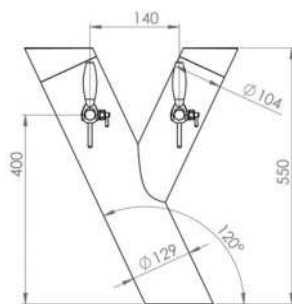

ANGLED X

2 TAPS

CUSTOMISE: COLOUR, SIZE, FIXATION

sku AX

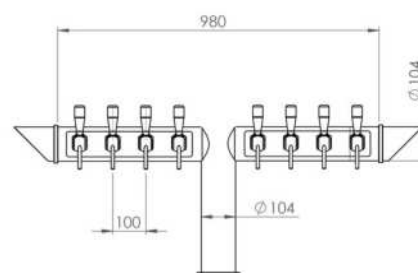
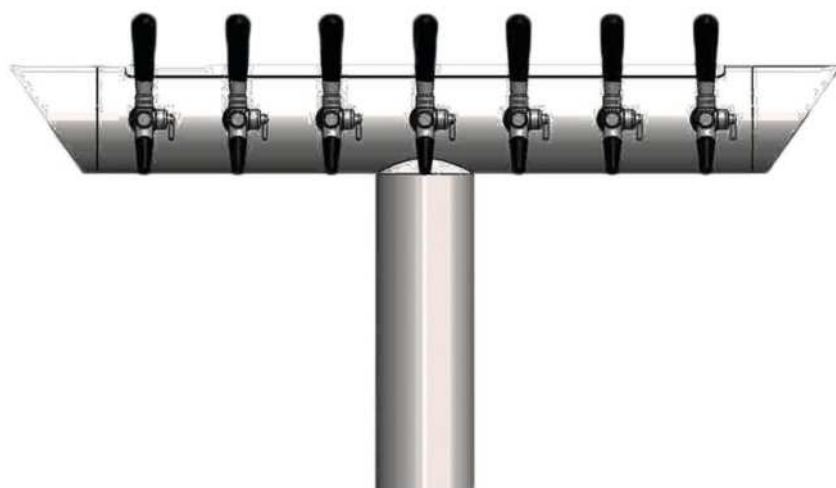

ANGLED T

4-9 TAPS

CUSTOMISE: COLOUR, SIZE, FIXATION

sku AT

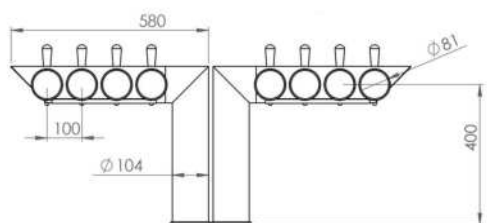

ANGLED LL

2+2, 3+3, 4+4, 5+5 TAPS

CUSTOMISE: COLOUR, SIZE, FIXATION

sku ALL



Elegant Line

A modern look with thin flanges and sophisticated finishes.
Many options of different sizes from XS-XL.



Colours

- SS- Stainless steel
- PVD Gold
- PVD Copper
- PC- Powder Coated- RAL to select
- WTP-Water transfer printing



Advertising

- Front Light
- Lollipop Light
- Laser Cut Light
- Digital Light
- Engraved Branding
- Laser Printed
- Wrapped Branding
- Tap Handles



Mounting

- Mounting Tube
- Mounting Screw
- Mounting Clamp



123 Cheers!

- Tap of your Choice
- Water-cooled Lines
- Drainer- Dimensions to select

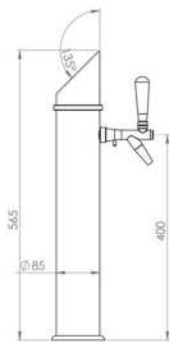

ELEGANT I-XS(Ø80)

1-2TAPS

CUSTOMISE: COLOUR, SIZE, FIXATION

sku EIXS

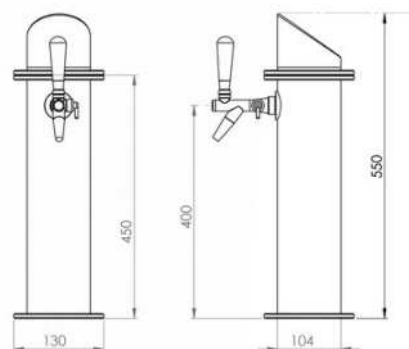

ELEGANT I-M(Ø104)

1-3TAPS

CUSTOMISE: COLOUR, SIZE, FIXATION

sku EIM

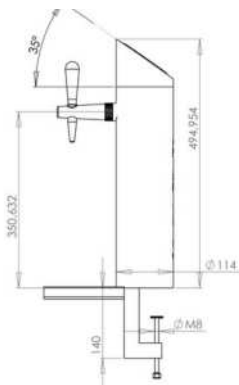

ELEGANT I-CLAMP

1-2TAPS

CUSTOMISE: COLOUR, SIZE, FIXATION

sku EIC



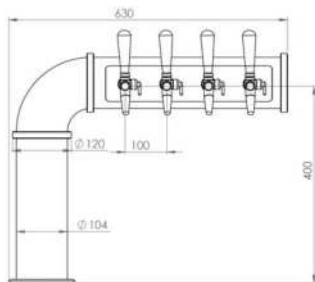

ELEGANT L

3-6TAPS

CUSTOMISE: COLOUR, SIZE, FIXATION

sku EL

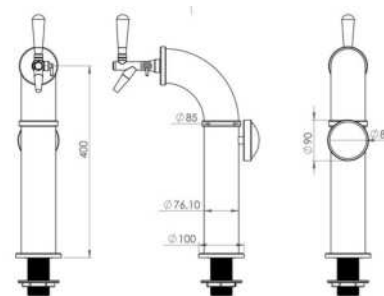

ELEGANT J XS-M

1-2TAPS

CUSTOMISE: COLOUR, SIZE, FIXATION

sku EJXS

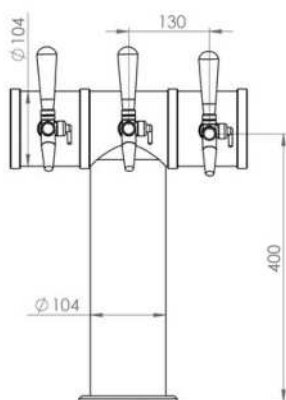

ELEGANT T

3-9TAPS

CUSTOMISE: COLOUR, SIZE, FIXATION

sku ET



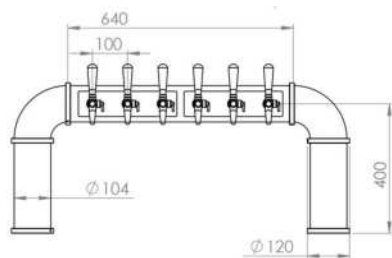

ELEGANT U-M(Ø104)

3-8TAPS

CUSTOMISE: COLOUR, SIZE, FIXATION

sku EUM

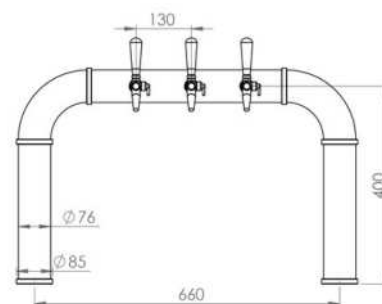

ELEGANT U-XS(Ø85)

3-6TAPS

CUSTOMISE: COLOUR, SIZE, FIXATION

sku EUXS

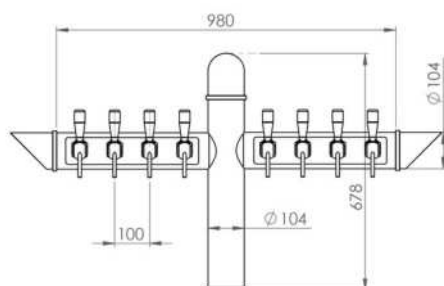

ELEGANT +

5-12TAPS

CUSTOMISE: COLOUR, SIZE, FIXATION

sku E+



Tailored Line

Tailored sheet metal. Cut, bent, welded and processed in all its glory. Due to its larger shape, it is very suitable for pouring carbonated drinks.



Colours

- SS- Stainless steel
- PVD Gold
- PVD Copper
- PC- Powder Coated- RAL to select
- WTP-Water transfer printing



Advertising

- Front Light
- Lollipop Light
- Laser Cut Light
- Digital Light
- Engraved Branding
- Laser Printed
- Wrapped Branding
- Tap Handles



Mounting

- Mounting Tube
- Mounting Screw
- Mounting Clamp



123 Cheers!

- Tap of your Choice
- Water-cooled Lines
- Drainer- Dimensions to select

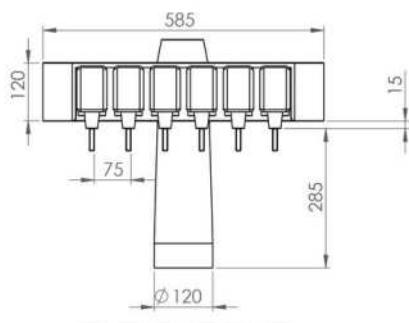

TAILORED COCA COLA

4-8TAPS

CUSTOMISE: COLOUR, SIZE, FIXATION

sku TCC

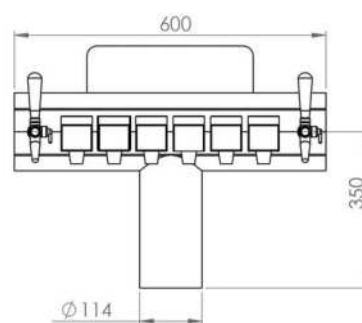

TAILORED PROBE PLEXI

3-10TAPS

CUSTOMISE: COLOUR, SIZE, FIXATION

sku TPP

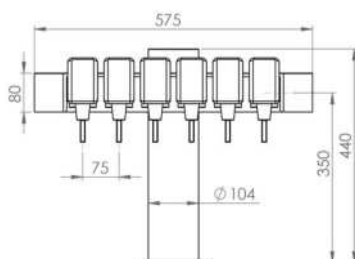

TAILORED SOFTY HAT

3-8TAPS

CUSTOMISE: COLOUR, SIZE, FIXATION

sku TSH



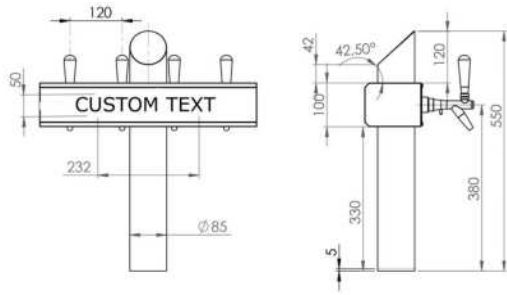

TAILORED T

3-6TAPS

CUSTOMISE: COLOUR, SIZE, FIXATION

sku TT

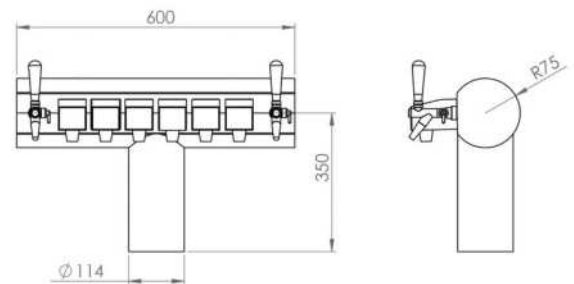

TAILORED PROBE LOLLIPOP

3-10TAPS

CUSTOMISE: COLOUR, SIZE, FIXATION

sku TPL

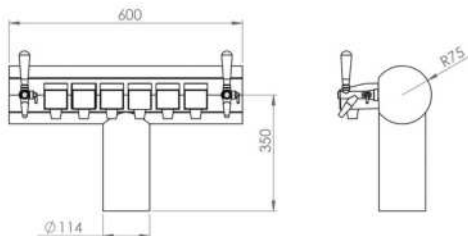

TAILORED PROBE

3-10TAPS

CUSTOMISE: COLOUR, SIZE, FIXATION

sku TP



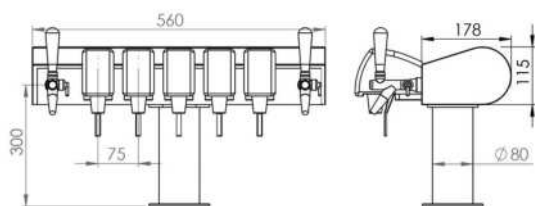

TAILORED SOFTY OVAL

3-8TAPS

CUSTOMISE: COLOUR, SIZE, FIXATION

sku TSO

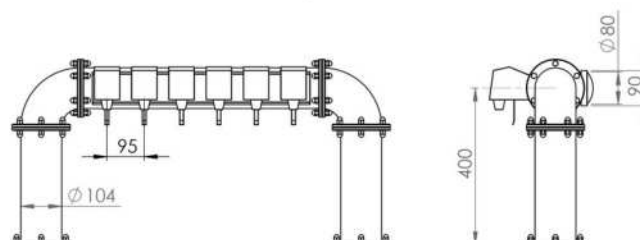

INDUSTRIAL U SOFTY

3-12TAPS

CUSTOMISE: COLOUR, SIZE, FIXATION

sku TUS

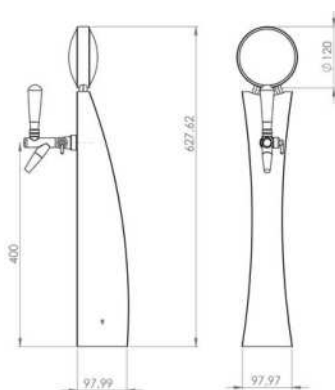

TAILORED I

1-2TAPS

CUSTOMISE: COLOUR, SIZE, FIXATION

sku TI



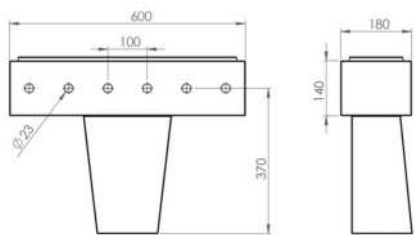

TAILORED V1

3-12TAPS

CUSTOMISE: COLOUR, SIZE, FIXATION

sku TV1



TAILORED +

3-8TAPS

CUSTOMISE: COLOUR, SIZE, FIXATION

sku T+



TAILORED V2

3-12TAPS

CUSTOMISE: COLOUR, SIZE, FIXATION

sku TV2



Cooper Line

Real copper material made in industrial style.
It can be plain, burned or aged- antique look.

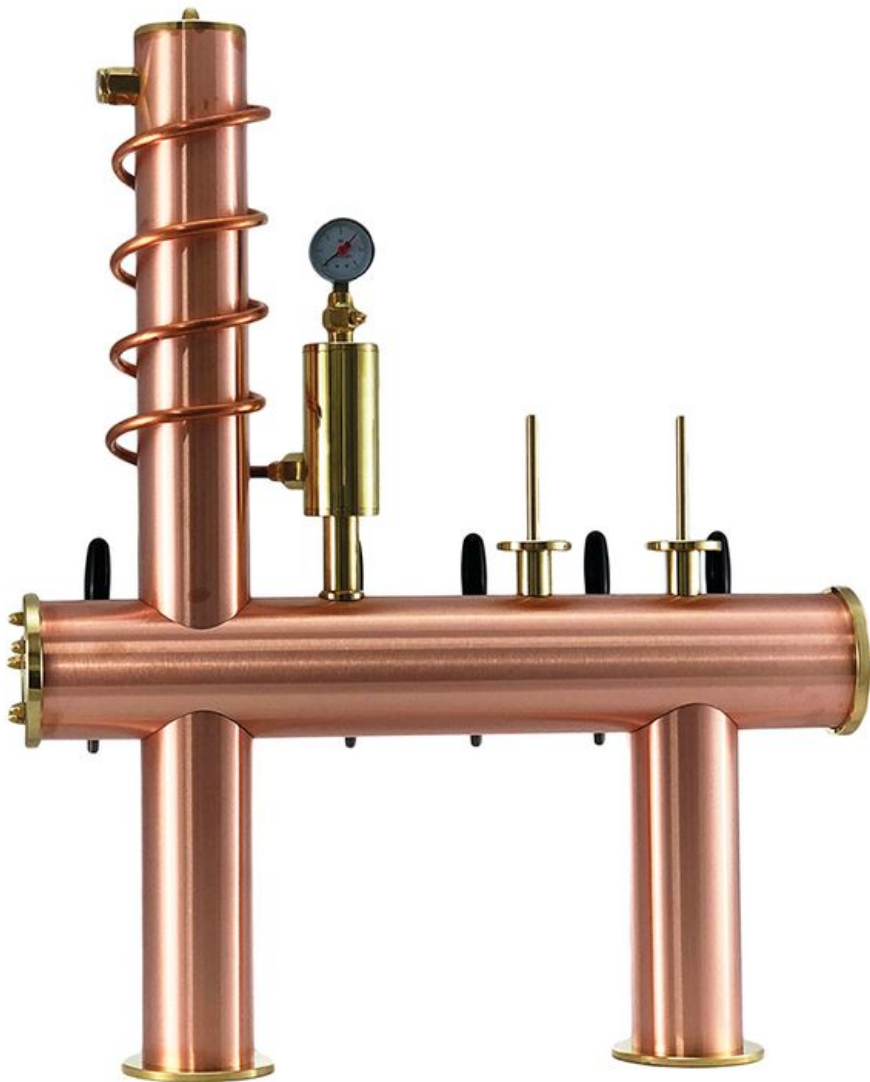

Colours

- SS- Stainless steel
- PVD Gold
- PVD Copper
- PC- Powder Coated- RAL to select
- WTP- Water transfer printing



Advertising

- Front Light
- Lollipop Light
- Laser Cut Light
- Digital Light
- Engraved Branding
- Laser Printed
- Wrapped Branding
- Tap Handles



Mounting

- Mounting Tube
- Mounting Screw
- Mounting Clamp



123 Cheers!

- Tap of your Choice
- Water-cooled Lines
- Drainer- Dimensions to select

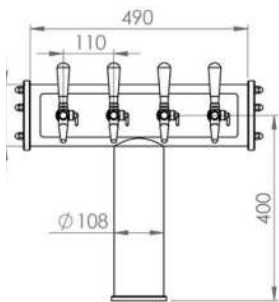

COOPER T

3-8TAPS

CUSTOMISE: COLOUR(plain, antique, burned),
SIZE, FIXATION

sku CT

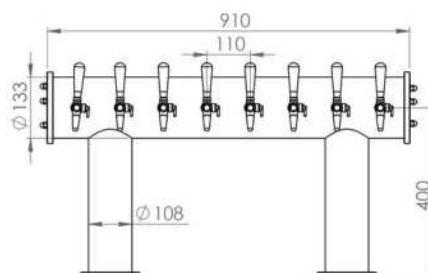
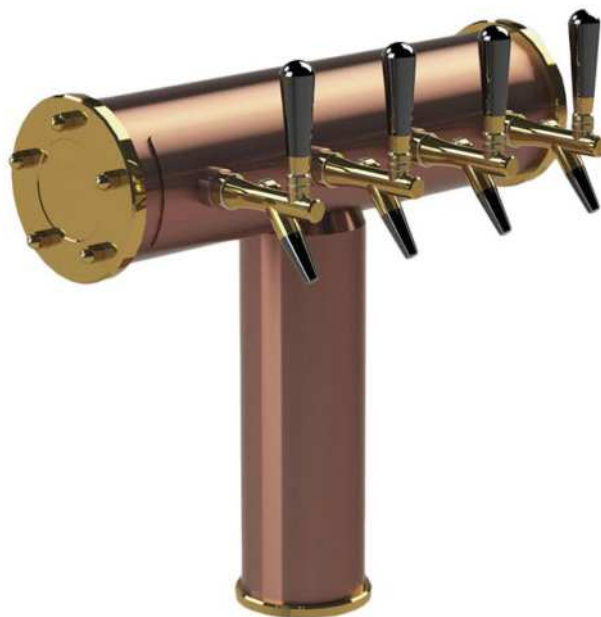

COOPER H

6-15TAPS

CUSTOMISE: COLOUR(plain, antique, burned),
SIZE, FIXATION

sku CH

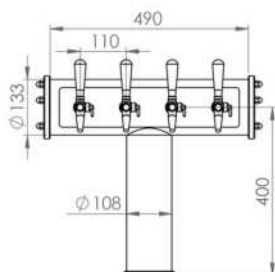

COOPER T-ANTIQUE

3-10TAPS

CUSTOMISE: COLOUR(plain, antique, burned),
SIZE, FIXATION

sku CTA



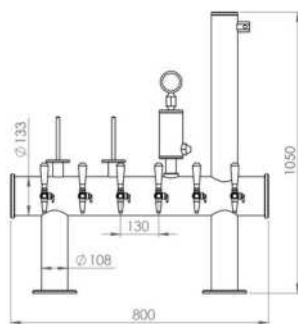

COOPER TEXAS

4-12TAPS

CUSTOMISE: COLOUR(plain, antique, burned),
SIZE, FIXATION

sku CTEX

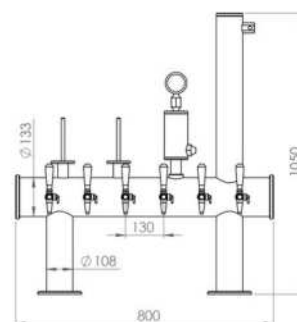

COOPER TEXAS BURNED

4-12TAPS

CUSTOMISE: COLOUR(plain, antique, burned),
SIZE, FIXATION

sku CTEXB

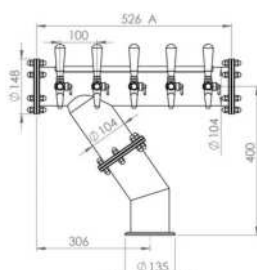

COOPER 7 BURNED

4-8TAPS

CUSTOMISE: COLOUR(plain, antique, burned),
SIZE, FIXATION

sku C7B



House Line

We are constantly developing and designing new attractive models. Our pool of ideas is full. The result are dispensers that are unique and can only be ordered from us.



Colours

- SS- Stainless steel
- PVD Gold
- PVD Copper
- PC- Powder Coated- RAL to select
- WTP-Water transfer printing



Advertising

- Front Light
- Lollipop Light
- Laser Cut Light
- Digital Light
- Engraved Branding
- Laser Printed
- Wrapped Branding
- Tap Handels



Mounting

- Mounting Tube
- Mounting Screw
- Mounting Clamp



123 Cheers!

- Tap of your Choice
- Water-cooled Lines
- Drainer- Dimensions to select

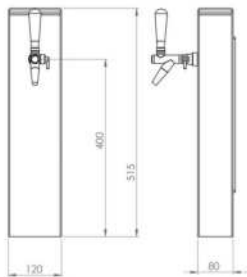

CHAMFER I

1TAP

CUSTOMISE: COLOUR, SIZE, FIXATION

sku HCI

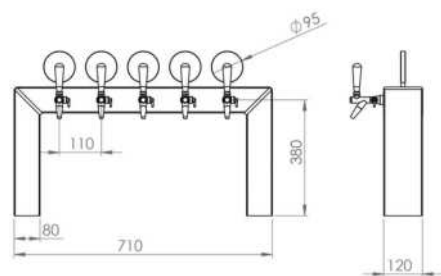

CHAMFER U

3-8TAPS

CUSTOMISE: COLOUR, SIZE, FIXATION

sku HCU

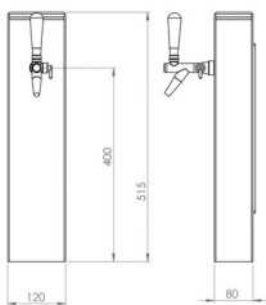

CHAMFER I2

1TAP

CUSTOMISE: COLOUR, SIZE, FIXATION

sku HCI2



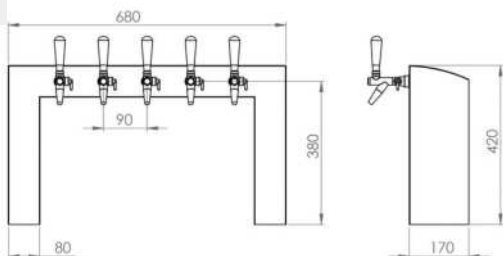

CHAMFER U2

3-10TAPS

CUSTOMISE: COLOUR, SIZE, FIXATION

sku HCU2

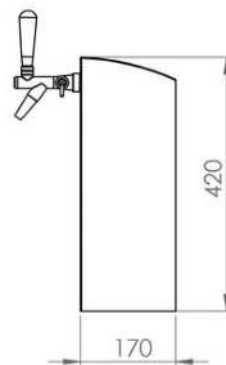

SLEEK I

1TAP

CUSTOMISE: COLOUR, SIZE, FIXATION

sku HSI

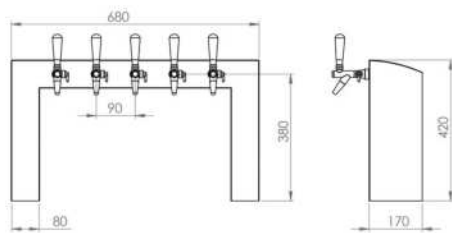

SLEEK U

3-8TAPS

CUSTOMISE: COLOUR, SIZE, FIXATION

sku HSU

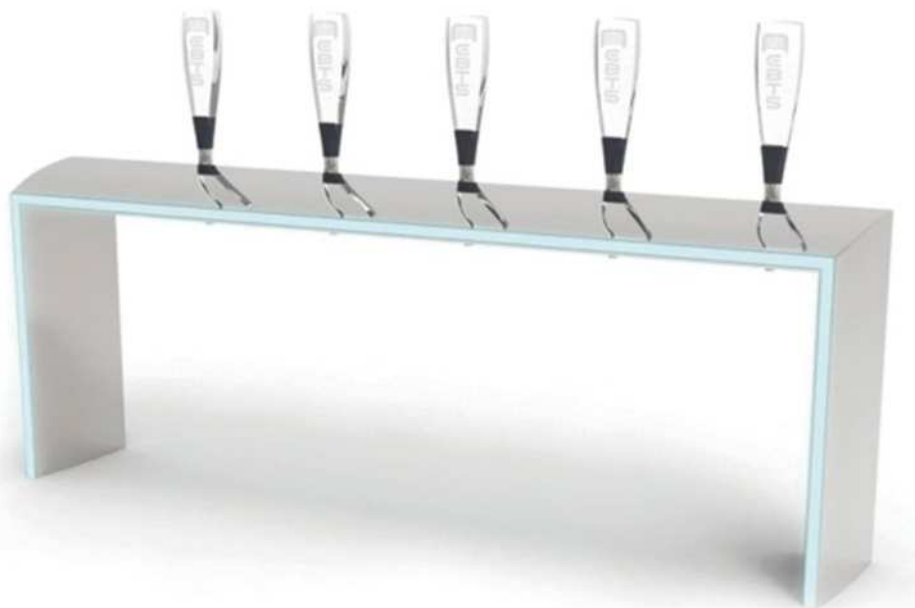

NEW 2024

Full of new ideas every year. Dispenser is a mirror of the bar and represent the image of your brand. We strive for an attractive appearance and thereby maintain all functionality and quality. These are this year's hot buns.



Colours

- SS- Stainless steel
- PVD Gold
- PVD Copper
- PC- Powder Coated- RAL to select
- WTP-Water transfer printing



Advertising

- Front Light
- Lollipop Light
- Laser Cut Light
- Digital Light
- Engraved Branding
- Laser Printed
- Wrapped Branding
- Tap Handels



Mounting

- Mounting Tube
- Mounting Screw
- Mounting Clamp



123 Cheers!

- Tap of your Choice
- Water-cooled Lines
- Drainer- Dimensions to select

NEW 2024- BOTTLENECK

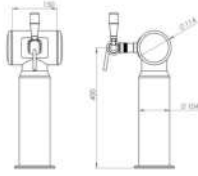

BOTTLENECK T1

1TAP

CUSTOMISE: COLOUR, SIZE, FIXATION

sku BT1

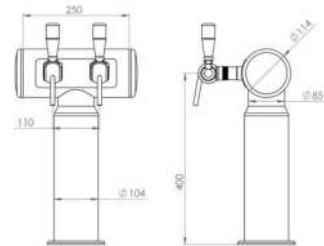

BOTTLENECK T2

2TAPS

CUSTOMISE: COLOUR, SIZE, FIXATION

sku BT2

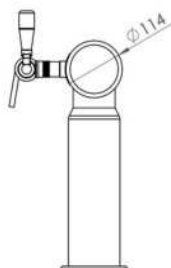
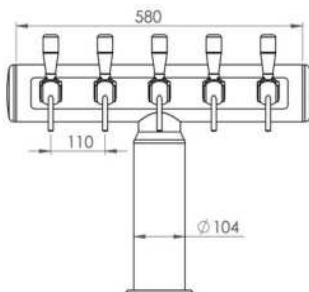

BOTTLENECK T

3-10TAPS

CUSTOMISE: COLOUR, SIZE, FIXATION

sku BT



NEW 2024- ELEMENT

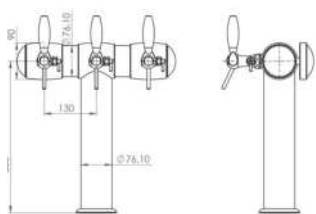

ELEMENT T

3-8TAP

CUSTOMISE: COLOUR, SIZE, FIXATION

sku ET

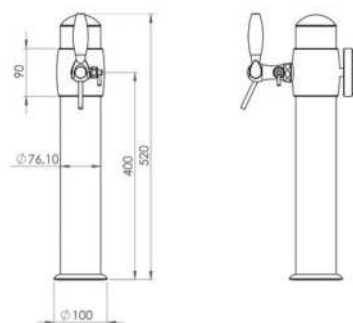

ELEMENT I

1TAPS

CUSTOMISE: COLOUR, SIZE, FIXATION

sku EI

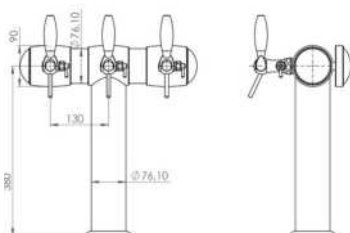

ELEMENT T-PVD GOLD

3-8TAPS

CUSTOMISE: COLOUR, SIZE, FIXATION

sku ET



NEW 2024-FUNNEL

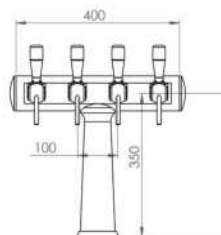

FUNNEL T2

2TAPS

CUSTOMISE: COLOUR, SIZE, FIXATION

sku FT2

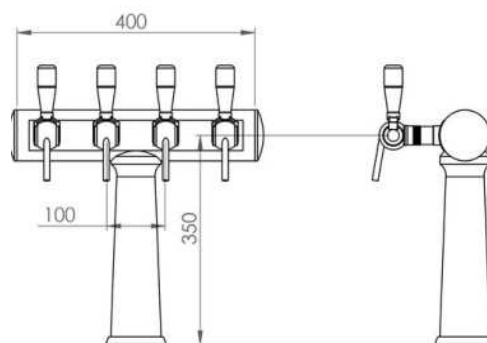

FUNNEL T

3-8TAPS

CUSTOMISE: COLOUR, SIZE, FIXATION

sku FT

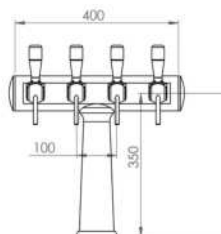

FUNNEL T2

2TAPS

CUSTOMISE: COLOUR, SIZE, FIXATION

sku FT2



NEW 2024-CFT



CFT T

2-5TAPS

CUSTOMISE: COLOUR, SIZE, FIXATION

sku CFTT



CFT I

1-2TAPS

CUSTOMISE: COLOUR, SIZE, FIXATION

sku CFTI



CFT T

2-5TAPS

CUSTOMISE: COLOUR, SIZE, FIXATION

sku CFTT



NEW 2024-ARC

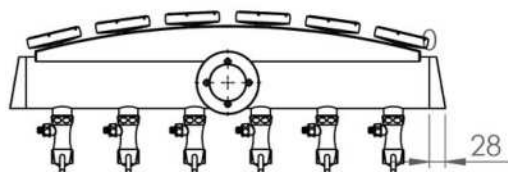

ARC T

3-6TAPS

CUSTOMISE: COLOUR, SIZE, FIXATION

sku ARCT

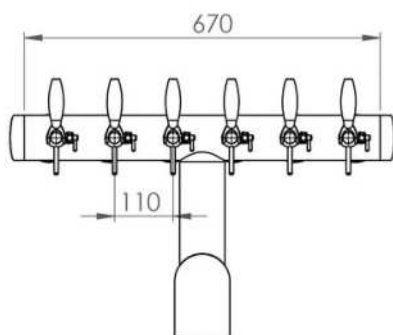
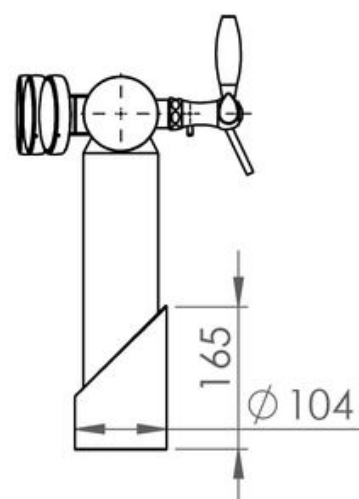
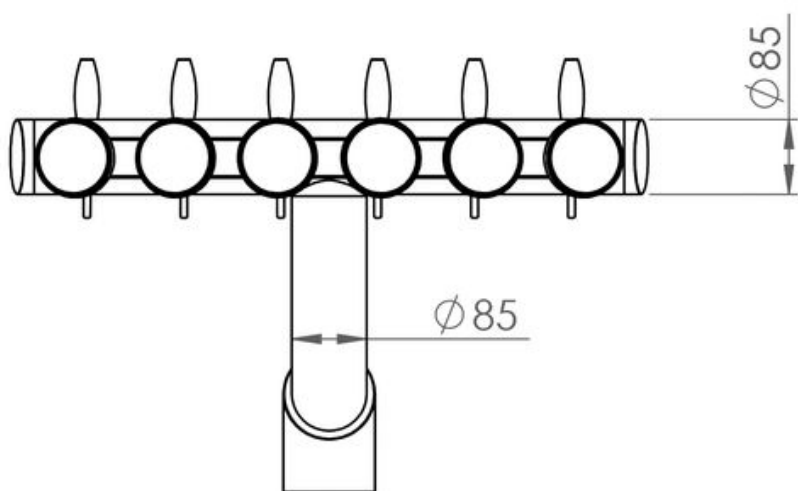

ARC T

3-6TAPS

CUSTOMISE: COLOUR, SIZE, FIXATIO

sku ARCT



Our work- let your imagination run wild

Almost every model can be customised to your liking. Indeed, all parameters are optional (size, colour, branding, attachment). Here are some unique results.



Colours

- SS- Stainless steel
- PVD Gold
- PVD Copper
- PC- Powder Coated- RAL to select
- WTP-Water transfer printing



Advertising

- Front Light
- Lollipop Light
- Laser Cut Light
- Digital Light
- Engraved Branding
- Laser Printed
- Wrapped Branding
- Tap Handles



Mounting

- Mounting Tube
- Mounting Screw
- Mounting Clamp



123 Cheers!

- Tap of your Choice
- Water-cooled Lines
- Drainer- Dimensions to select



Basic H-Red



Basic L-Black, Laser cut light

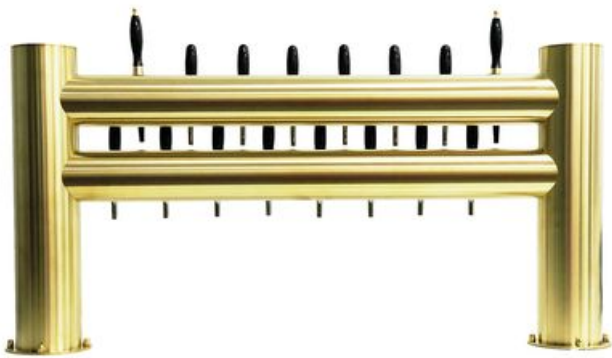

Basic H2- PVD Gold



Industrial T-Pink/
Polished flanges



Industrial U-XS-
Violet/Brushed flanges



Industrial 7-Black



Basic Tree -Black

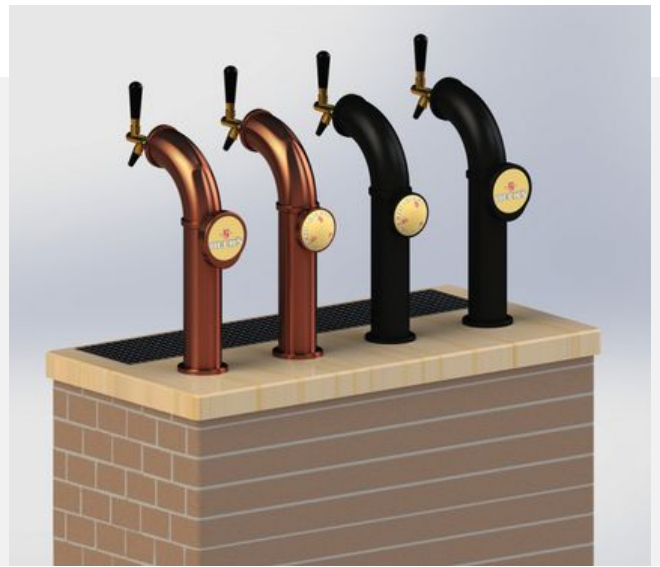

Elegant J-Black, front light



Basic Cactus- Green



Basic Capsula, Green



Industrial T2-PVD
Copper



Industrial U-Blue,
Lollipop light



Angled LL-Black/Orange



Elegant U-xs-PVD
Copper



Industrial U-Red,
Lollipop light



Industrial U-M,
Black/Brushed flanges



Elegant T- PC
Antique, Front light



Basic I- Black,
Laser cut light



Basic I- White, Laser cut light



Basic I-Black, Laser cut light, Front light



Silo-Cream, Laser cut light, Front integrated light



Tailored Fatty- White, Front integrated light



Industrial I-Black, Lollipop light, Laser cut light



Basic I-Black, Laser cut light



Basic I-Kirin Laser cut
light



Angled I-Kirin
Engraving



Industrial I2-
Engraved/laser printed



Angled I- Acrylic top
engraved light, WTP wood



Basic I-Panorama
light, Front light



Element I-Heineken,
Front light

Illuminated Branding

The choice of branding is large and offers endless presentation possibilities



Front Light

- flat & fish eye shape
- different dimensions: 65, 80, 82mm
- illuminated & non-illuminated
- optional- integrated



Lollipop Light

- flat & fish eye shape
- one & double sided
- different dimensions: 65, 80, 82mm
- illuminated & non-illuminated



Laser Cut Light

Text, logo or panel can be cut out.

We play with different colours and foil designs to give the illuminated surface a good look



Digital Light

Connect with your customers in matters of seconds with dynamic content. Wifi upload to all the bars no matter of where they are.

Non-Illuminated Branding



Engraved Branding

Laser engraving is a branding method where the logo is burned into the material. The result is very precise. The colour of the produced logo depends on the substrate and the lower layers of the workpiece.



Laser Printed Branding

A decorative technique that allows you to apply detailed patterns and artwork onto all models. It makes the look of the same model completely different.



Wrapped Branding

A decorative technique that allows you to apply detailed patterns and artwork onto all models. It makes the look of the same model completely different.



Tap Handles

Good presentation option. Suits all taps models as it has a universal thread. They are available in various materials- wood, plastic, metal. Colours, shapes and sizes to select.



Thank you

FOR CHOOSING .

Cheers!

if you think you have seen
it all, flip again



EBTS D.O.O.
Ljubljanska 45D
Kamnik 1241
Slovenia
EU

CONTACT US:
info@ebts.si
+386(0)51 682 860
+386(0)1 830 11 15
www.draftbeertowers.com